

INSTALLATION INSTRUCTIONS: APEX CARGO BASKET FOR MODULAR PACK RACK



INSTALLATION DIFFICULTY: EASY

INSTALLATION TIME: 1 HOUR

REQUIRED TOOLS:

INCLUDED COMPONENTS

- 2 x Side Rail
- 2 x Front/Rear Valance
- 2 x Floor Pieces

INCLUDED HARDWARE

18 x 5/16 button head bolt (18 washers, lock washers and nuts)

12 x 1/4 button head bolt (12 washers, lock washers and nuts)

6 x Rubber Vibration dampening pad



PROCESS:

- 1.) Account for all components and hardware. Gather tools.
- 2.) Begin assembly starting with one valance and one side rail. Attach the side rail to the valance using 3/4 button head bolts, and subsequent related hardware.



- 3.) Attach other side rail to opposite side of valance in the same way as above.



- 4.) Slide one of the flooring pieces in between the rails until the holes line up. Using the 5/16 bolts, bolt the flooring to the side pieces. Leave the end and middle bolts out as these are the bolts which attach it to the modular pack rack.

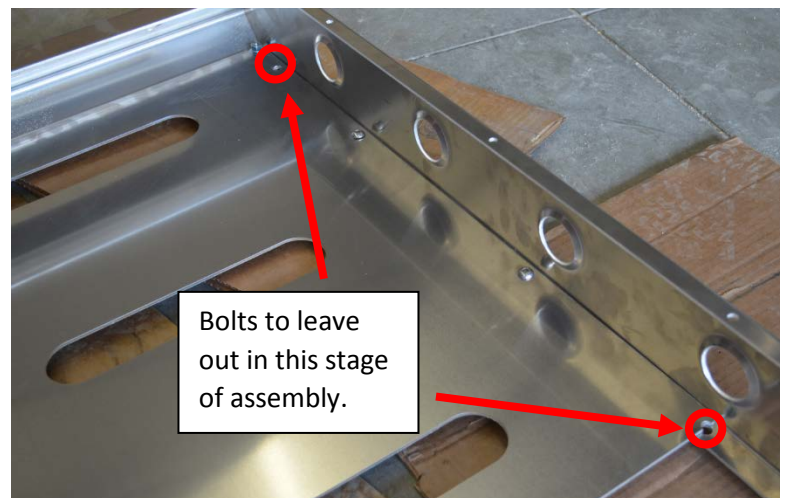

5.) Slide other half of flooring into place. Bolt in same manner as the first plate.

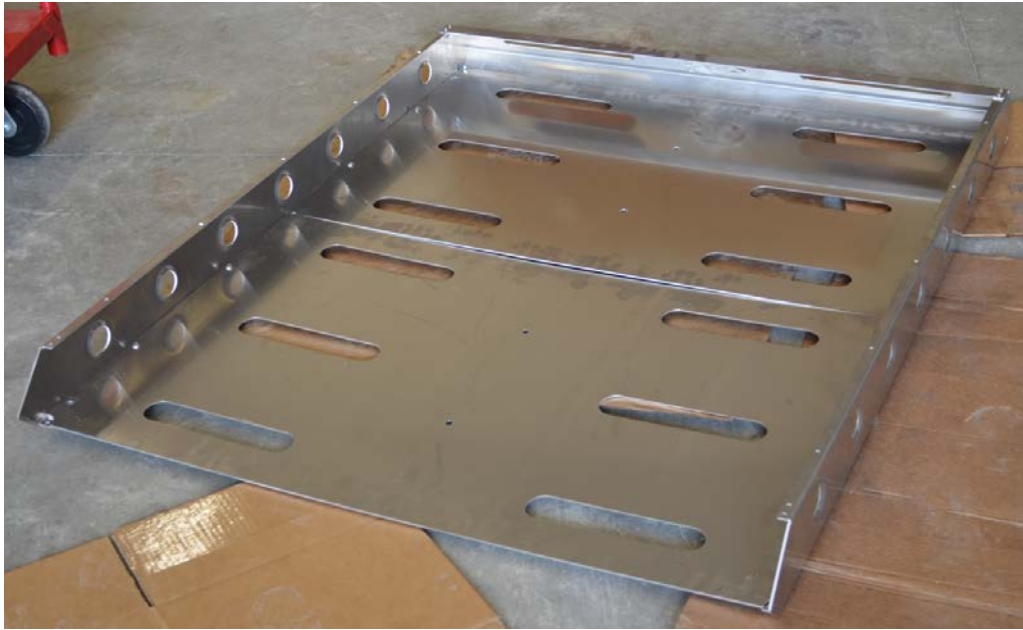

6.) Attach the rear valance using the supplied 1/4 bolts like in the first step.

